

# Bronze Globe Valve (Transformer)

PN16 • S I B • Rising Stem • One End Flanged • Locking Type

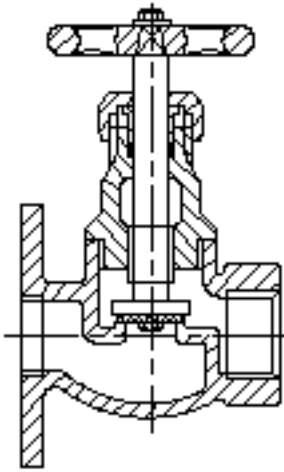

## Product no. 122300BLSF

### Size Range:

1/2 through 2 inches  
Max. temperature limit is 450°F (232°C)

### Working Pressures / Temperature Rating:

50 lbs/in<sup>2</sup> at 250 °F Transformer Oil  
3.5 bar at 121 °C Transformer Oil  
650 kPa at 121 °C Transformer Oil

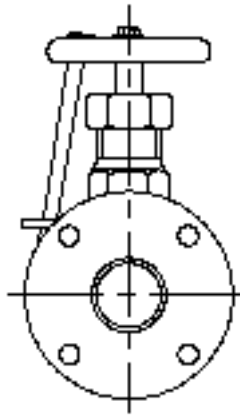

## Features

- Rising Stem
- Screwed Bonnet
- Flanged Ends are plain faces with two v-shaped concentric grooves between the port and bolt holes.
- PTFE Gland Packing and Seat Disc
- Integral Bronze Seat
- Powder Coated Aluminium Handwheel
- Recommended for Transformer Oil
- Disc Holder Spun with stem up to size 2" and above retained by a threaded ring
- Powder Coated Locking Rod for Padlock

For more details please contact:  
export@oswalvalve.com

::

Above size 4" also available on request

TESTING HYDROSTATIC: BODY: 24 Kg/Cm<sup>2</sup>  
SEAT : 16 Kg/Cm<sup>2</sup>

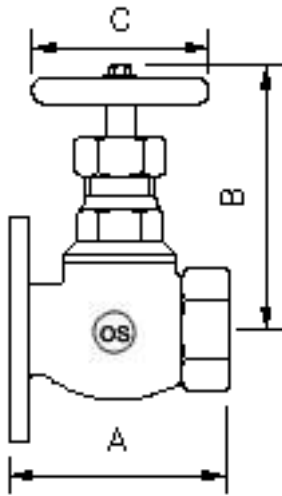

## Principal Parts & Materials

Part	Material	BS
Body	Bronze	1400 LG2
Bonnet	Bronze	1400 LG2
Disc	Bronze	1400 LG2
Stem	Brass	2874 CZ124

## Dimensions and Weights

Millimeters - Kilograms

DN	1/2" 15	3/4" 20	1" 25	1 1/4" 32	1 1/2" 40	2" 50	2 1/2" 65	3" 80	4" 100
A	70	80	90	100	115	135	165	185	215
B	90	110	120	140	155	170	210	225	280
C	60	65	75	75	95	110	125	125	175
WTS.	1.10	1.50	2.40	3.00	5.00	5.80	8.60	12.20	22.70