

Bronze Globe Valve (Transformer)

PN16 • S I B • Rising Stem • Flanged Ends • Locking Rod

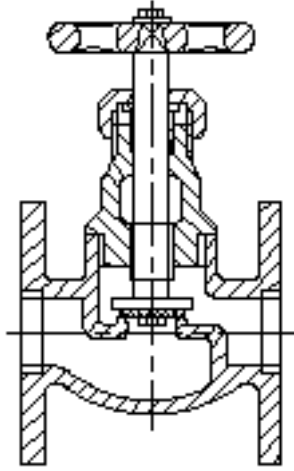

Product no. 122200BL

Size Range:

1/2 through 4 inches
Max. temperature limit is 450°F (232°C)

Working Pressures / Temperature Rating:

50 lbs/in² at 250 °F Transformer Oil
3.5 bar at 121 °C Transformer Oil
650 kPa at 121 °C Transformer Oil

Features

- Rising Stem
 - Screwed Bonnet
 - Flanged Ends are plain faces with two v-shaped concentric grooves between the port and bolt holes.
 - PTFE Gland Packing and Seat Disc
 - Integral Bronze Seat
 - Powder Coated Aluminium Handwheel
 - Recommended for Transformer Oil
 - Powder Coated Locking Rod for Padlock
 - Disc Holder Spun with stem up to size 2" and above retained by a threaded ring
- For more details please contact:
export@oswalvalve.com

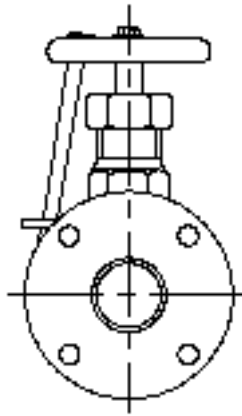

Above size 4" also available on request

TESTING HYDROSTATIC: BODY: 24 Kg/Cm²
SEAT : 16 Kg/Cm²



Principal Parts & Materials

Part	Material	BS
Body	Bronze	1400 LG2
Bonnet	Bronze	1400 LG2
Disc	Bronze	1400 LG2
Stem	Brass	2874 CZ124

Dimensions and Weights

Millimeters - Kilograms

DN	1/2" 15	3/4" 20	1" 25	1 1/4" 32	1 1/2" 40	2" 50	2 1/2" 65	3" 80	4" 100
A	80	90	100	110	120	135	165	185	230
B	90	110	120	140	155	170	210	225	280
C	60	65	75	75	95	110	125	125	175
WTS.	1.30	1.60	2.50	3.80	5.00	6.20	10.30	14.50	26.30