

# Bronze Globe Valve (Transformer)

**Class 150 • S I B • Rising Stem • One End Flanged • Locking Type**

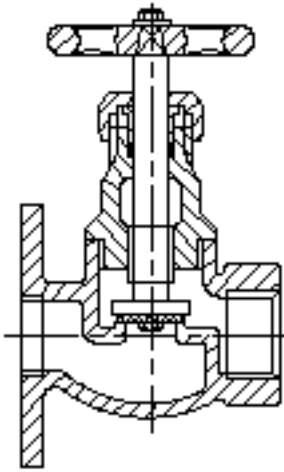

### Product no. 122300ALSF

#### Size Range:

1/2 through 2 inches  
Max. temperature limit is 450°F (232°C)

#### Working Pressures / Temperature Rating:

50 lbs/in<sup>2</sup> at 250 °F Transformer Oil  
3.5 bar at 121 °C Transformer Oil  
650 kPa at 121 °C Transformer Oil

### Features

- Rising Stem
- Screwed Bonnet
- Flanged Ends are plain faces with two v-shaped concentric grooves between the port and bolt holes.
- PTFE Gland Packing and Seat Disc
- Integral Bronze Seat
- Powder Coated Aluminium Handwheel
- Recommended for Transformer Oil
- Disc Holder Spun with stem up to size 2" and above retained by a threaded ring
- Powder Coated Locking Rod for Padlock

For more details please contact:  
export@oswalvalve.com

::

Above size 4" also available on request

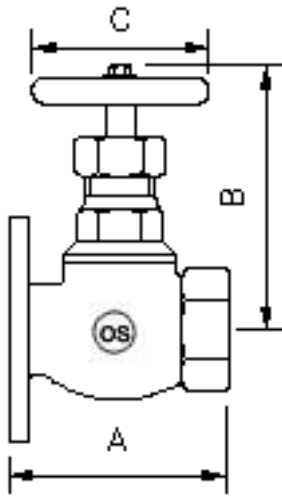
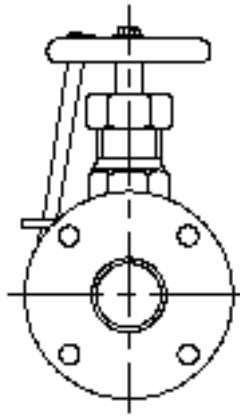

TESTING HYDROSTATIC: BODY: 24 Kg/Cm<sup>2</sup>  
SEAT : 16 Kg/Cm<sup>2</sup>

### Principal Parts & Materials

Part	Material	ASTM
Body	Bronze	B62 alloy 83600
Bonnet	Bronze	B62 alloy 83600
Disc	Bronze	B62 alloy 83600
Stem	Brass	B21 alloy C48200

### Dimensions and Weights

Millimeters - Kilograms

DN	1/2" 15	3/4" 20	1" 25	1 1/4" 32	1 1/2" 40	2" 50	2 1/2" 65	3" 80	4" 100
A	70	80	90	100	115	135	165	185	215
B	90	110	120	140	155	170	210	225	280
C	60	65	75	75	95	110	125	125	175
WTS.	1.10	1.60	2.50	4.70	5.70	6.00	8.40	12.50	22.40