

# Bronze Globe Valve (Transformer)

**Class 150 • S I B • Rising Stem • Flanged Ends • Locking Rod**

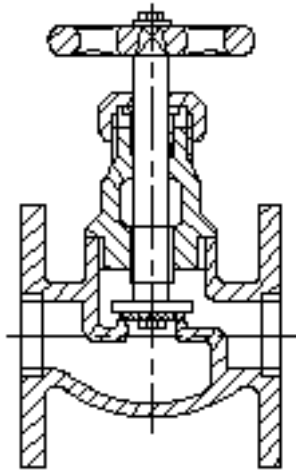

**Product no. 122200AL**

**Size Range:**

1/2 through 4 inches  
Max. temperature limit is 450°F (232°C)

**Working Pressures / Temperature Rating:**

50 lbs/in<sup>2</sup> at 250 °F Transformer Oil  
3.5 bar at 121 °C Transformer Oil  
650 kPa at 121 °C Transformer Oil

**Features**

- Rising Stem
  - Screwed Bonnet
  - Flanged Ends are plain faces with two v-shaped concentric grooves between the port and bolt holes.
  - PTFE Gland Packing and Seat Disc
  - Integral Bronze Seat
  - Powder Coated Aluminium Handwheel
  - Recommended for Transformer Oil
  - Powder Coated Locking Rod for Padlock
  - Disc Holder Spun with stem up to size 2" and above retained by a threaded ring
- For more details please contact:  
export@oswalvalve.com

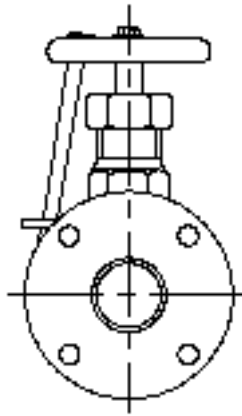

Above size 4" also available on request

TESTING HYDROSTATIC: BODY: 24 Kg/Cm<sup>2</sup>  
SEAT : 16 Kg/Cm<sup>2</sup>

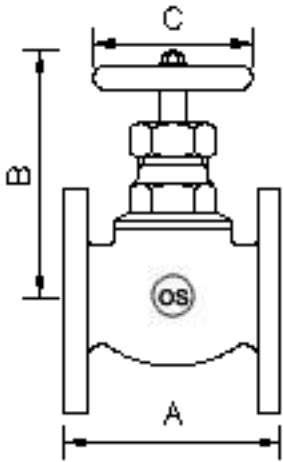

**Principal Parts & Materials**

Part	Material	ASTM
Body	Bronze	B62 alloy 83600
Bonnet	Bronze	B62 alloy 83600
Disc	Bronze	B62 alloy 83600
Stem	Brass	B21 alloy C48200

**Dimensions and Weights**

Millimeters - Kilograms

DN	1/2" 15	3/4" 20	1" 25	1 1/4" 32	1 1/2" 40	2" 50	2 1/2" 65	3" 80	4" 100
A	80	90	100	110	120	135	165	185	230
B	90	110	120	140	155	170	210	225	280
C	60	65	75	75	95	110	125	125	175
WTS.	1.60	2.20	3.40	5.50	7.00	7.50	10.40	14.50	25.00