

# Bronze Gate Valve (Transformer)

**Class 2 • S I B • Non-Rising Stem • Flanged Ends • Locking Rod**

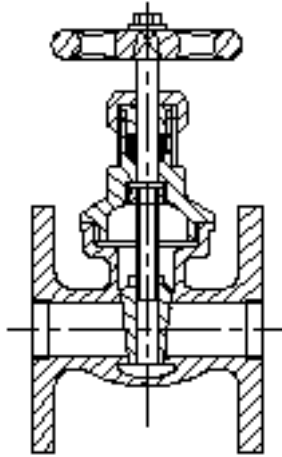

## Product no. 111200IL

### Size Range:

1/2 through 4 inches  
Max. temperature limit is 450°F (232°C)

### Working Pressures / Temperature Rating:

50 lbs/in<sup>2</sup> at 250 °F Transformer Oil  
3.5 bar at 121 °C Transformer Oil  
650 kPa at 121 °C Transformer Oil

## Features

- Non Rising Stem
- Screwed Bonnet
- Flanged Ends are plain faces with two v-shaped concentric grooves between the port and bolt holes.
- Full Ports
- PTFE Gland Packing
- Integral Bronze Seat
- Recommended for Transformer Oil
- Powder Coated Aluminium Handwheel
- Powder Coated M. S. Locking Rod

For more details please contact:  
[export@oswalvalve.com](mailto:export@oswalvalve.com)

Above size 4" also available on request

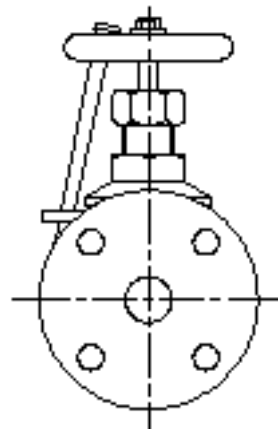

TESTING HYDROSTATIC: BODY: 24 Kg/Cm<sup>2</sup>  
SEAT : 16 Kg/Cm<sup>2</sup>

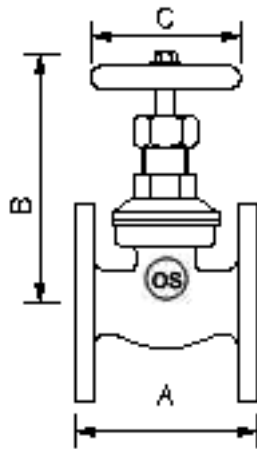

## Principal Parts & Materials

Part	Material	IS
Body	Bronze	318 LTB2
Bonnet	Bronze	318 LTB2
Disc	Bronze	318 LTB2
Stem	Brass	319 GR 2

## Dimensions and Weights

Millimeters - Kilograms

DN	1/2" 15	3/4" 20	1" 25	1 1/4" 32	1 1/2" 40	2" 50	2 1/2" 65	3" 80	4" 100
A	72	76	90	100	110	120	140	150	190
B	100	115	120	145	165	185	235	255	315
C	60	65	75	75	95	110	125	125	175
WTS.	1.20	1.60	2.50	3.10	5.20	6.00	8.90	12.50	23.20